

**PINK PROVIDES:**

- 1 Apollo Fabric
- 4 5' Fiberglass Rods
- 4 1' Fiberglass Rods
- 1 2' -6" Fiberglass Rods
- 1 18" Plastic Tube
- 1 Plastic Coupling (sewn in fabric)
- 1 Pole and Base Cover
- Extra Rods
- Extra Brass Couplings
- Extra White End Caps





**YOU PROVIDE:**

- 12' Auto-Pole and Base Plate or Tie line for rigging
- Site Plan/Event Layout
- Two Person Team
- Shears or Diagonal Cutters
- Zip-Ties
- Gloves
- Sewing Kit
- Plastic Drop Cloth

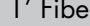
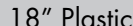

Additional Support Please Call:  
212-253-6666 or  
After Hours: 646-853-3900

Be sure to have these pieces near the final location.

- 5' Fiberglass Rod  x 4
- 2' -6" Fiberglass Rod  x 1
- 1' Fiberglass Rod  x 4
- 18" Plastic Tube  x 1
- Plastic Coupling (sewn in fabric)  x 1

Prior to assembly, lay out drop cloth in designated work location. Before working with fabric, wash hands or put on gloves.

1. Lay out fabric on plastic drop cloth and identify the following parts:

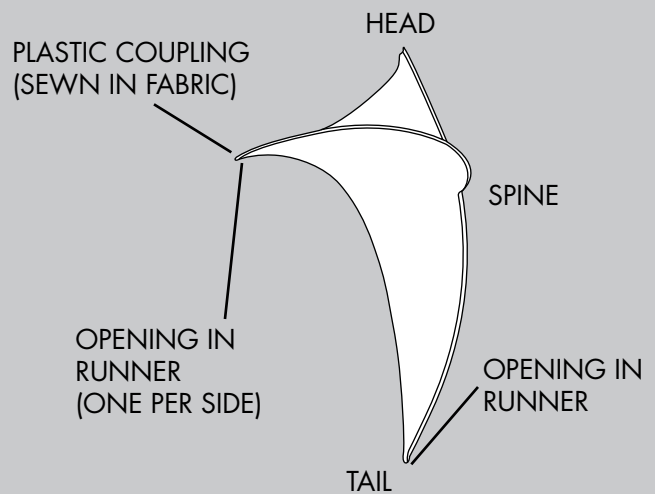

2. If the plastic coupling is sewn in, skip to step 3. In the unlikely event that the coupling has become un-stitched, please locate and re-insert into the opening of the runner; slide it back into the corner.

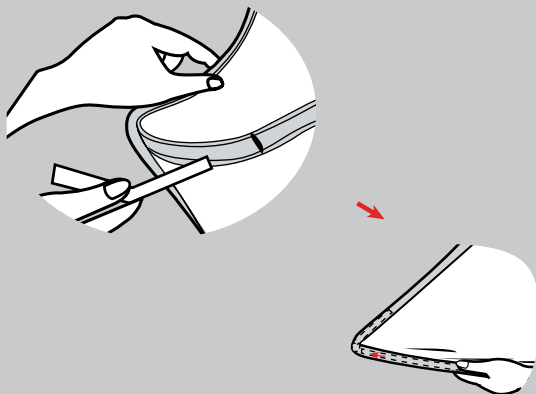

3. Locate the 18" plastic tube, and insert the it into one of the openings in the runner that goes around the whole piece. Do not insert past the end of the tube.

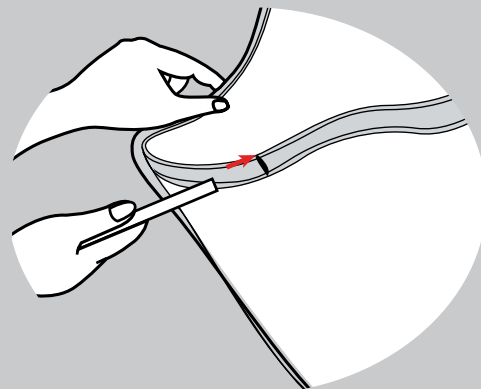

Any and all rights (including, without limitation, copyright, design patent, use patent and trademark) in and to all designs, concepts, renderings, or graphics (collectively, "Design") represented in this document were created by Moss Inc. and remain the sole and exclusive property of Moss Inc. Use of any such Design by the recipient without required purchase is strictly prohibited. ©2010

4. Into the tube insert one of the 5' rods with a white end cap. Do not insert past the brass coupling.



Take a 1' rod and insert its open end into the 5' rod's brass coupling. Feed the 1' rod into the runner as well but do not insert past its brass coupling.

5. Locate another 1' rod (without a brass coupling) and insert into the brass coupling of the previous 1' rod. Insert the rod fully into the runner. Allow it to return to the corner and into the plastic coupling at the corner.

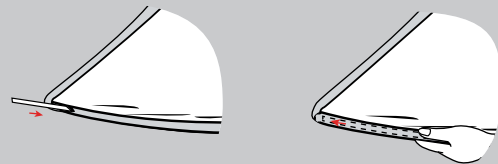
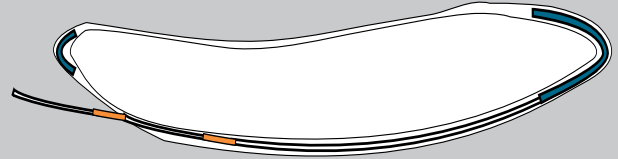

6. Repeat steps 3 - 5 with the opposite side.

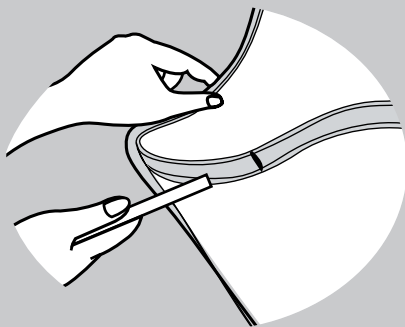

While one person is inserting the rod into the fabric, have the other person make sure that the 5' rod gets inserted into the 18" tube.

7. To pipe the spine, locate one of the 5' rods with both a white end cap and a brass coupling. Insert the white end cap end first, but do not insert past the brass coupling.

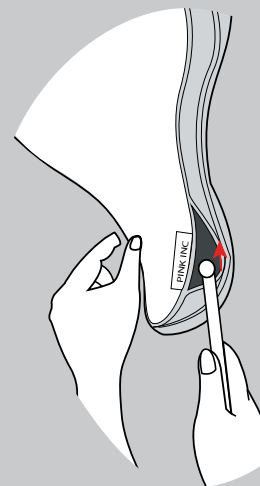

Any and all rights (including, without limitation, copyright, design patent, use patent and trademark) in and to all designs, concepts, renderings, or graphics (collectively, "Design") represented in this document were created by Moss Inc. and remain the sole and exclusive property of Moss Inc. Use of any such Design by the recipient without required purchase is strictly prohibited. ©2010

8. Into the brass coupling, insert another 5' rod. Repeat this with the remaining 2' -6" rod.

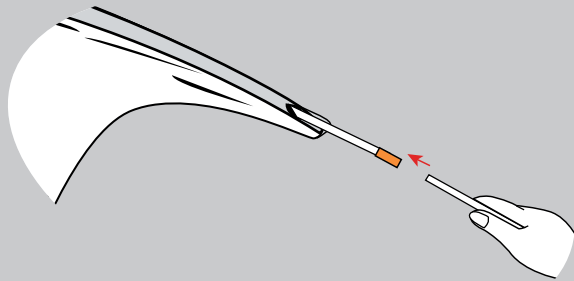

9. The 2' -6" rod should have a white end cap on before being inserted. Insert it fully into the runner and allow it to return to the corner.

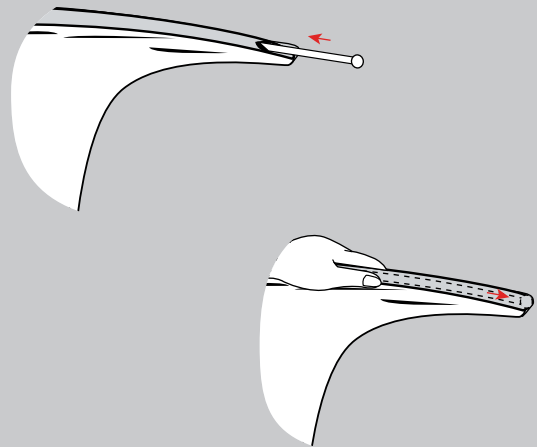

10. The Apollo is piped. Lay the fabric onto the drop cloth while you prep the auto-pole and base. For rigging, skip to step 19.

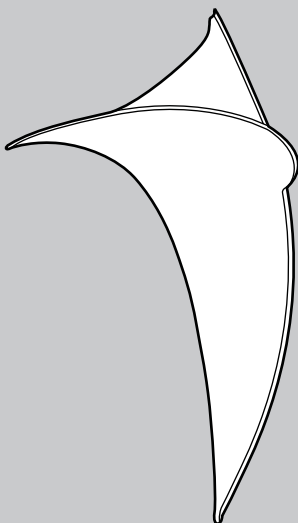

11. If base plate is not assembled, assemble with nipple.

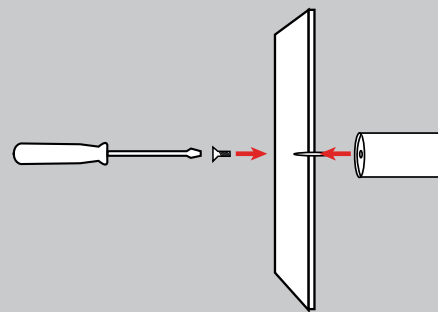

Any and all rights (including, without limitation, copyright, design patent, use patent and trademark) in and to all designs, concepts, renderings, or graphics (collectively, "Design") represented in this document were created by Moss Inc. and remain the sole and exclusive property of Moss Inc. Use of any such Design by the recipient without required purchase is strictly prohibited. ©2010

12. Place the base cover onto the base plate as indicated below.

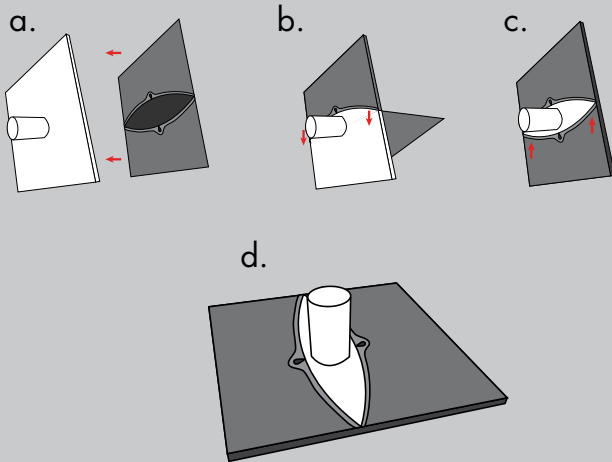

13. Preset the auto-pole to the correct height. Slide the pole cover over the auto-pole. Then place auto-poles onto base plates.

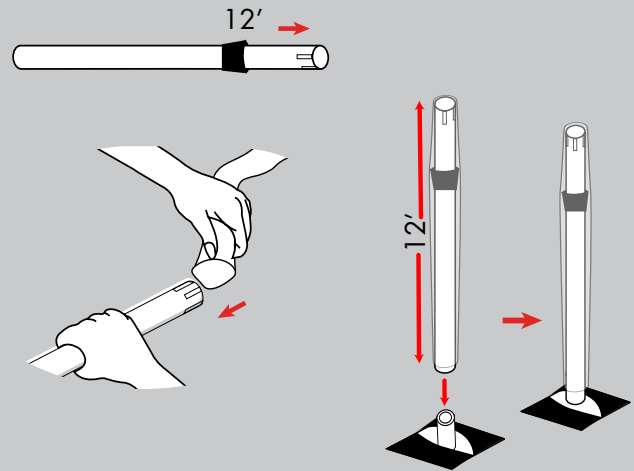

14. Locate the fabric. Have one person tilt the auto-pole at the base. Inside the fabric is a pole sock that is attached to the center of the top. Pull the sock out through the bottom and place onto the pole.

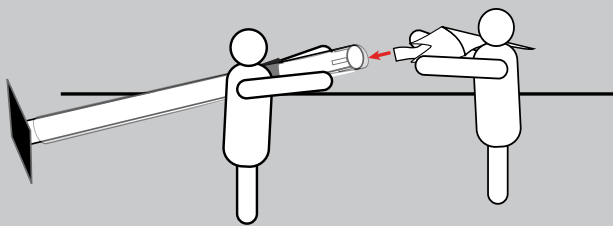

15. Stretch the fabric onto the pole and stand the Apollo. To finish, have one person hold the TAIL of the fabric down, while the other person zip-ties the base cover to the loop at the TAIL end.

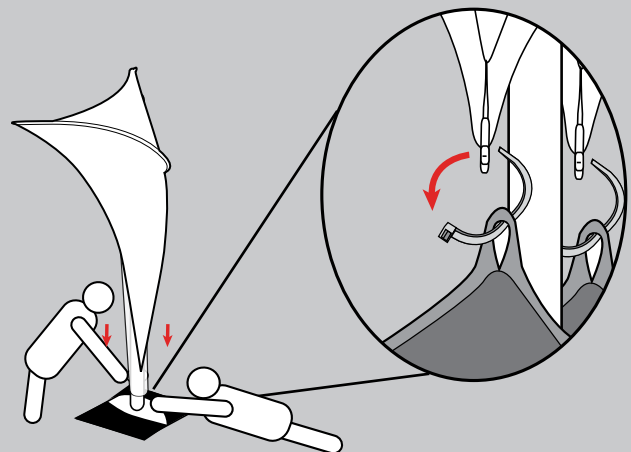

Any and all rights (including, without limitation, copyright, design patent, use patent and trademark) in and to all designs, concepts, renderings, or graphics (collectively, "Design") represented in this document were created by Moss Inc. and remain the sole and exclusive property of Moss Inc. Use of any such Design by the recipient without required purchase is strictly prohibited. ©2010

16. After it is zip-tied, the Apollo is finished.

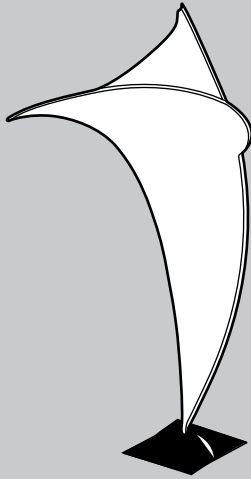

17. The Apollo can be rigged by attaching tie line to the loops located at the top and bottom. →

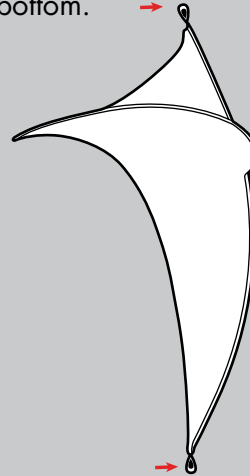

Loops exaggerated in drawing.

18. The Apollo can be rigged on an angle or upside down. Just be sure that the structure is stretched to 12' to ensure proper tension.

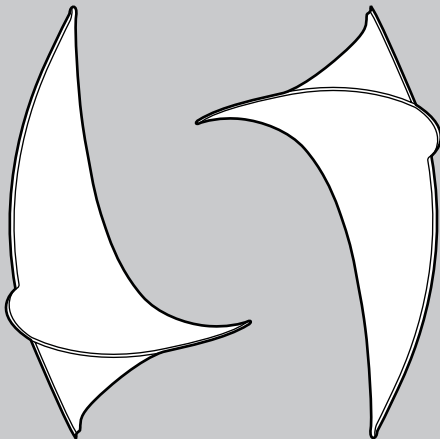

Fiberglass precautions:

- \* Do not run hand along rod;
  - \* Wear gloves;
  - \* Handle gently to avoid breaking rod.
- If you get a fiberglass splinter:
- \* Wash hands with soap and water;
  - \* Treat as a splinter.
- If a fiberglass rod breaks:
- \* Do not re-use; throw away;
  - \* Replace with extra provided.
- If fabric appears wrinkled, stretch the auto-pole taller.

Any and all rights (including, without limitation, copyright, design patent, use patent and trademark) in and to all designs, concepts, renderings, or graphics (collectively, "Design") represented in this document were created by Moss Inc. and remain the sole and exclusive property of Moss Inc. Use of any such Design by the recipient without required purchase is strictly prohibited. ©2010