

PINK PROVIDES:

- 1 Set of Wave Wall Large Metals
- 1 Set of Large Slope Metals
- 1 Set of Small Slope Metals
- 1 Continental Divide Fabric
- Extra Pop Buttons

YOU PROVIDE:

- Site Plan/Event Layout
- Four Person Team
- Gloves
- Sewing Kit
- Plastic Drop Cloth
- Allen Key Set
- Ladders

- Shears or Diagonal Cutters
- Zip-Ties

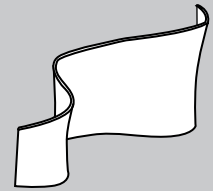

Additional Support Please Call:
212-253-6666 or
After Hours: 646-853-3900

Metals are labeled for easy assembly. Simply match the corresponding parts, depress the button, and slide together.

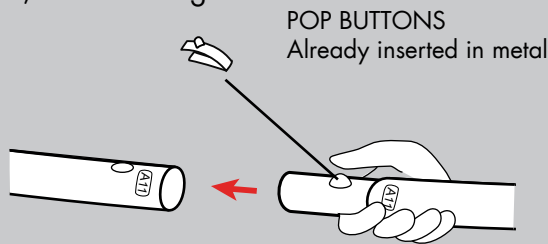

Prior to assembly, lay out drop cloth in designated work location. Before working with fabric, wash hands or put on gloves.

1. First locate the Large Wave Wall and begin assembly. Combine the curved pieces and straight pieces.

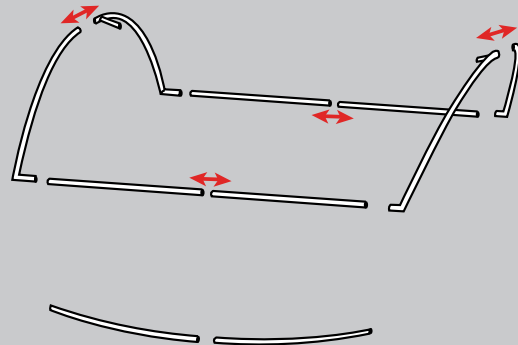

2. Join Sections. Begin with the curves, followed by the straight supports.

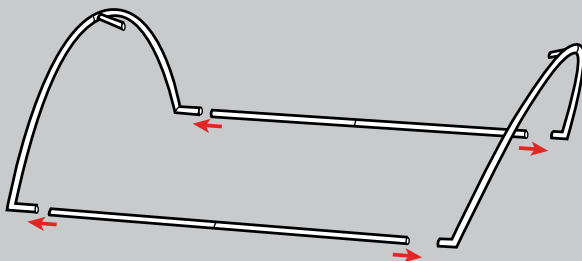

3. Attach the central supports to the curved ends. Join the center last.

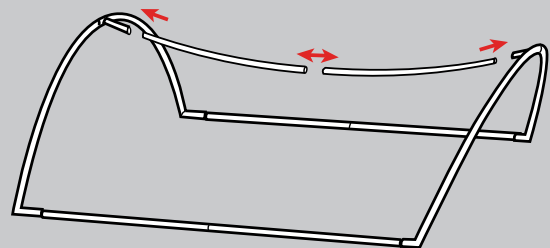

Any and all rights (including, without limitation, copyright, design patent, use patent and trademark) in and to all designs, concepts, renderings, or graphics (collectively, "Design") represented in this document were created by Moss Inc. and remain the sole and exclusive property of Moss Inc. Use of any such Design by the recipient without required purchase is strictly prohibited. ©2010

4. Stand the Wave Wall and set to the side. Now assemble the Large Slope. Begin by joining the pieces to create sections. Combine the curved and straight pieces. The top will be a different shape than the Large Wave Wall.

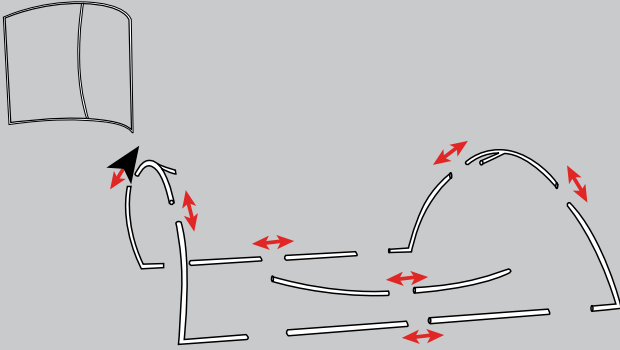

5. If comfortable with metal assembly, have two people move to step 7.

Join sections. Begin with the curves, followed by the straight supports.

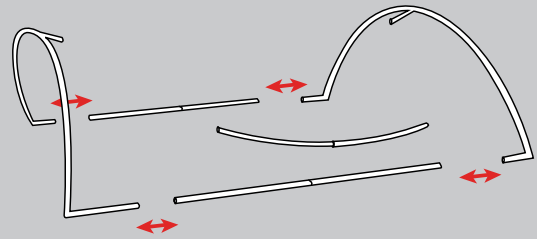

6. Attach the central supports to the curved ends. Join the center last. Depending on the frame sent, the centers will either pop into place or you will need an allen key.

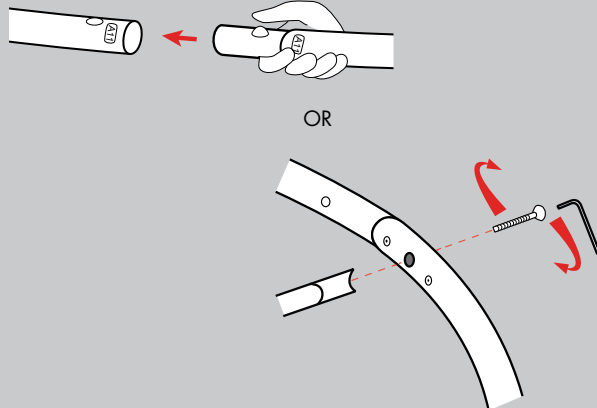

7. Stand this piece up and place next to the Wave Wall Large. It is time for the Small Slope. Combine the curved pieces and straight pieces. It is very similar to the Large Slope.

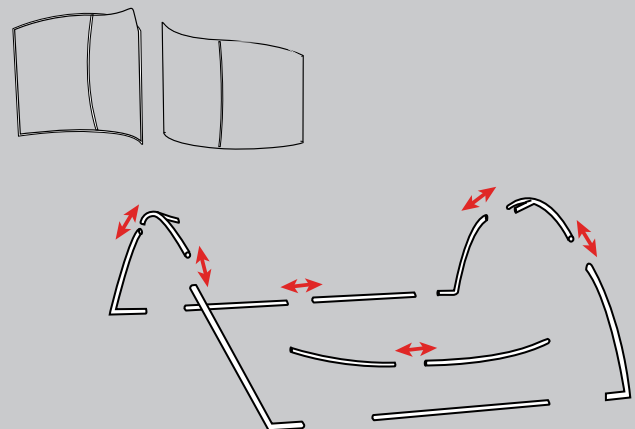

Any and all rights (including, without limitation, copyright, design patent, use patent and trademark) in and to all designs, concepts, renderings, or graphics (collectively, "Design") represented in this document were created by Moss Inc. and remain the sole and exclusive property of Moss Inc. Use of any such Design by the recipient without required purchase is strictly prohibited. ©2010

8. Join Sections. Begin with the curves, followed by the straight supports.

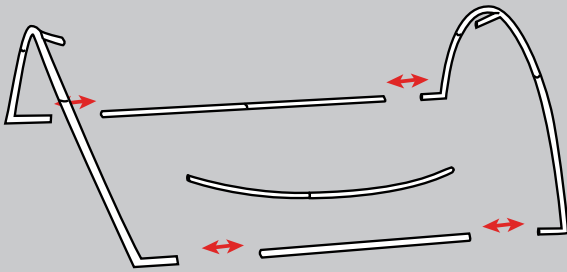

9. Attach the central supports to the curved ends. Join the center last. Depending on the frame sent, the centers will either pop into place or you will need an allen key.

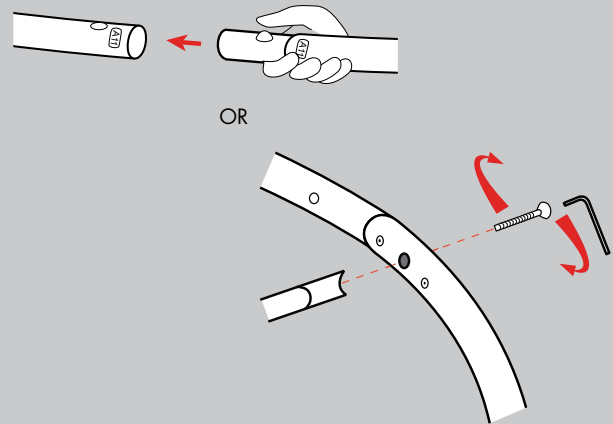

10. Align the three walls in the following sequence, tallest to shortest. Wave Wall Large > Large Slope > Small Slope. Make sure that the adjacent slopes have different designations (Left or Right). The shapes of the curves should alternate from one another as shown below.

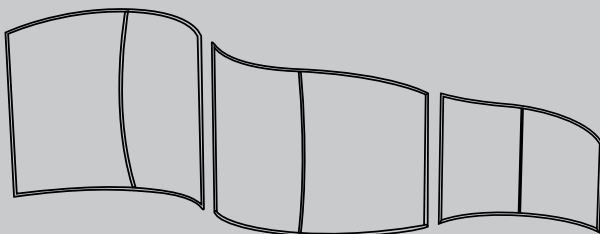

11. Using zip-ties, connect the metals at the top, middle, and bottom. It is best to use 2 zip-ties at the top and 2 at the bottom.

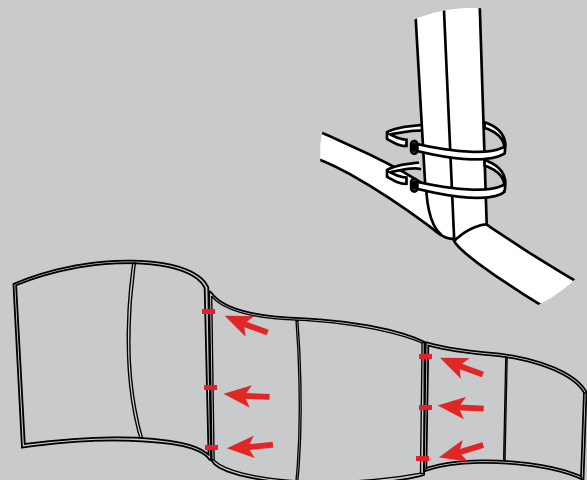

Any and all rights (including, without limitation, copyright, design patent, use patent and trademark) in and to all designs, concepts, renderings, or graphics (collectively, "Design") represented in this document were created by Moss Inc. and remain the sole and exclusive property of Moss Inc. Use of any such Design by the recipient without required purchase is strictly prohibited. ©2010

12. It is very important that the tails of the zip-ties are cut off completely and that the eyelet is rotated to be in line with the metals.

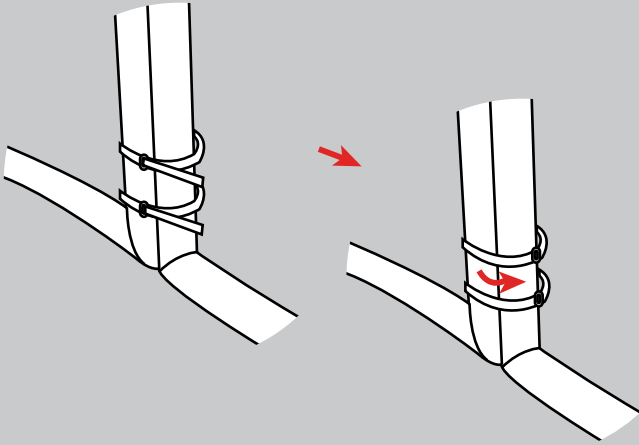

13. Locate the fabric. Spread the fabric and unzip. The zipper runs from top to bottom along the side of the Large Wave Wall. The open zipper ends at the top edge.

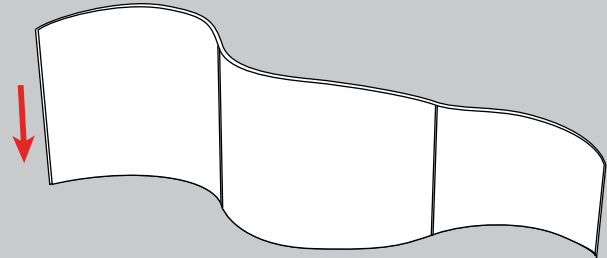

Zipper shown in red.

14. Begin sliding the fabric onto the shortest end of the Small Slope frame. Remember that the person with the zipper end will be running along the top edge.

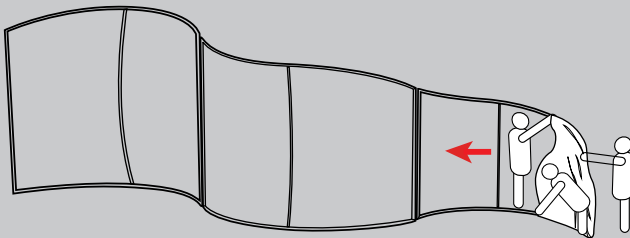

15. As the fabric is slid over the taller parts of the Divide, a ladder or two may be necessary to continue sliding the fabric along the top.

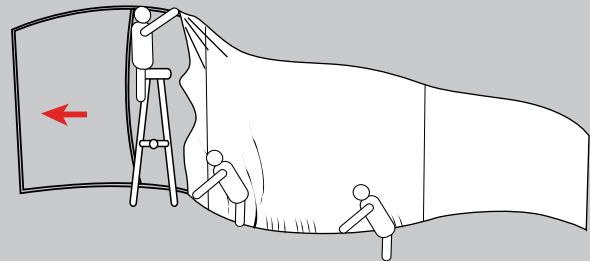

Any and all rights (including, without limitation, copyright, design patent, use patent and trademark) in and to all designs, concepts, renderings, or graphics (collectively, "Design") represented in this document were created by Moss Inc. and remain the sole and exclusive property of Moss Inc. Use of any such Design by the recipient without required purchase is strictly prohibited. ©2010

16. The fabric may seem too short. If this happens, go back to the short end and pull and gather fabric until you move the excess towards the large end. This is most effective when one person works the top and another the bottom on alternate sides at the same time.

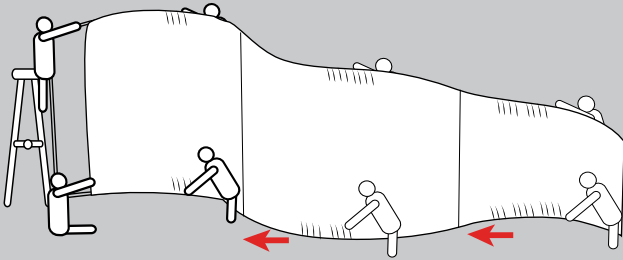

Have two other people stay at the large end holding the fabric at top and bottom, pulling lightly.

17. At the end, have one person pull the fabric over the metal while another one zips. The fabric is strong, so we encourage pulling hard!

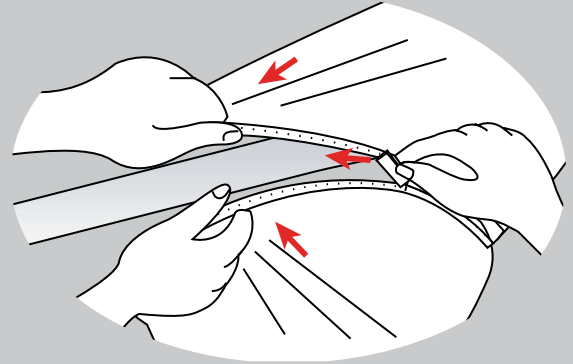

18. Make sure corners and seams are straight. Align metals to create a smooth curving Continental Divide.

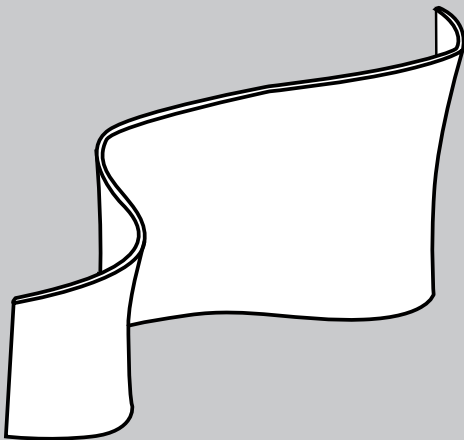

Final Notes:

Metals:

After use, dismantle. Each metal is labeled, so please place back in corresponding labeled bag. If possible, zip-tie pieces together.

Under **NO** circumstances should the metals be taped to one another.

Fabric

Each fabric is labeled on the Pink Inc. tag and should be placed back in the corresponding labeled bag.

Any and all rights (including, without limitation, copyright, design patent, use patent and trademark) in and to all designs, concepts, renderings, or graphics (collectively, "Design") represented in this document were created by Moss Inc. and remain the sole and exclusive property of Moss Inc. Use of any such Design by the recipient without required purchase is strictly prohibited. ©2010