

**PINK PROVIDES:**

- 1 Set of Flat Metals
- 1 Flat Fabric
- Extra Pop Buttons

**YOU PROVIDE:**

- Site Plan/Event Layout
- Two Person Team
- Gloves
- Sewing Kit
- Plastic Drop Cloth
- Allen Key Set



Additional Support Please Call:  
212-253-6666 or  
After Hours: 646-853-3900

Metals are labeled for easy assembly. Simply match the corresponding parts, depress the button, and slide together.

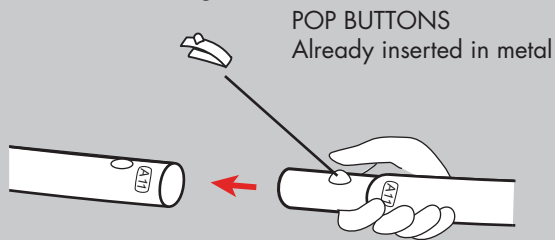

Prior to assembly, lay out drop cloth in designated work location. Before working with fabric, wash hands or put on gloves.

1. Assemble the metal pieces labeled **TOP BAR** and **BASE BAR FRONT**.

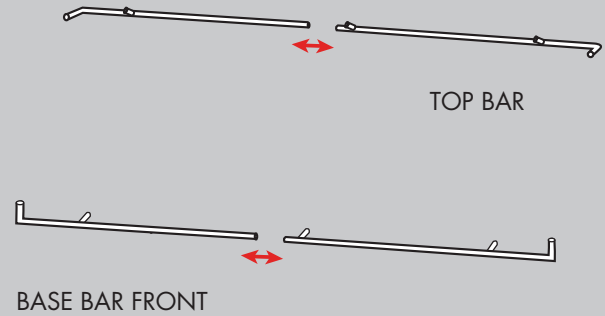

2. Join the two **BASE BAR REAR** bars to the bottom center support.

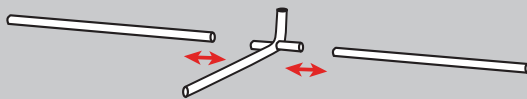

3. Using an allen key, remove the screws from the ends of the **BASE BAR REAR** pieces. Use these screws to attach the corner pieces to the **BASE BAR REAR**.

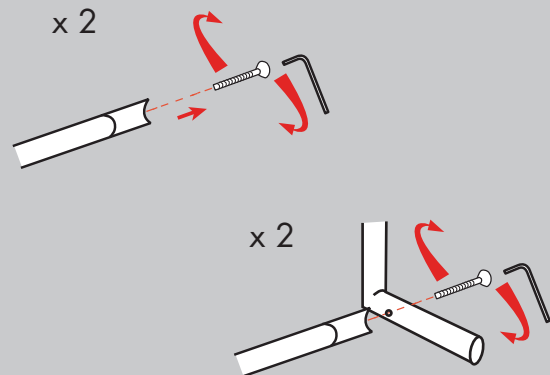

Any and all rights (including, without limitation, copyright, design patent, use patent and trademark) in and to all designs, concepts, renderings, or graphics (collectively, "Design") represented in this document were created by Moss Inc. and remain the sole and exclusive property of Moss Inc. Use of any such Design by the recipient without required purchase is strictly prohibited. ©2010

4. Attach the **BASE BAR REAR** to the **BASE BAR FRONT**. Attach the two metal plates between the two using the provided bolts. You now have completed the **BASE**. Set it aside until step 7.

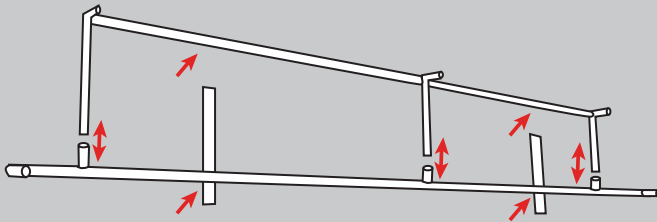

5. Join together the straight and curved support pieces.

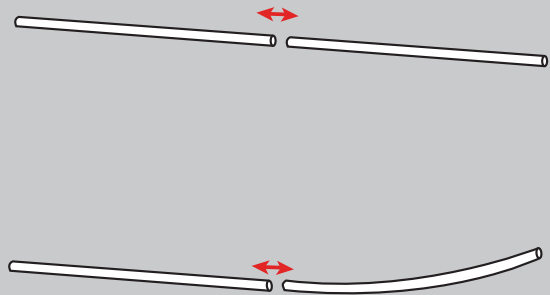

6. All straight and curved support pieces must be attached to the **TOP BASE BAR** before proceeding to step 7. Lay the structure "flat side down." Once pieces are attached, the **MAIN STRUCTURE** is complete.

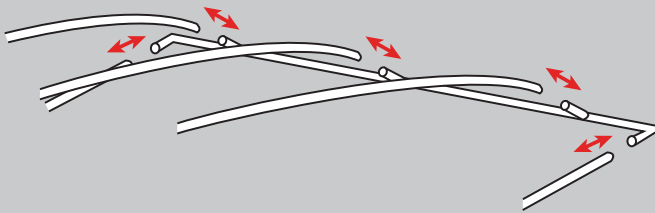

7. Beginning with the curved pieces, attach the **MAIN STRUCTURE** to the **BASE**. Work from the center outward. Repeat step 7 with the straight support pieces.

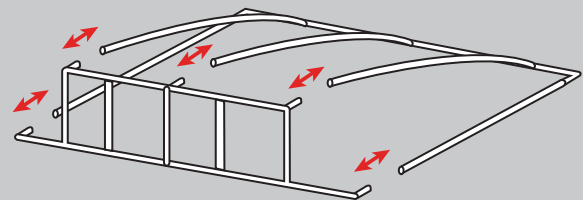

Any and all rights (including, without limitation, copyright, design patent, use patent and trademark) in and to all designs, concepts, renderings, or graphics (collectively, "Design") represented in this document were created by Moss Inc. and remain the sole and exclusive property of Moss Inc. Use of any such Design by the recipient without required purchase is strictly prohibited. ©2010

8. Locate the fabric, unzip it, and spread it out between two people. The person holding the zipper end will be sliding the fabric along the top of the Flat. Have each person grasp a corner from inside the fabric.

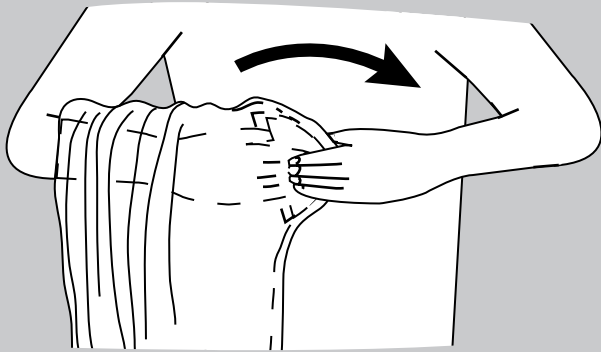

9. Continue holding each corner. Transfer the fabric from one arm to the other so it becomes inside-out.

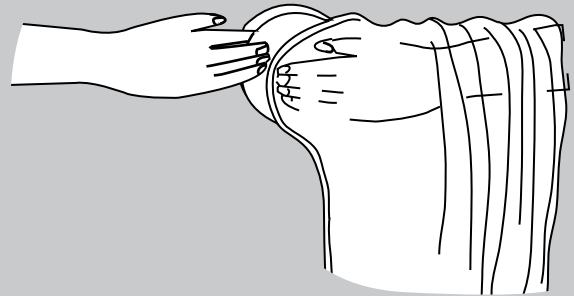

10. Have each person grasp one of the two top metal corners with the hand inside the fabric. Continue holding the corner as you begin stretching the fabric over the metal towards the bottom of the Flat.

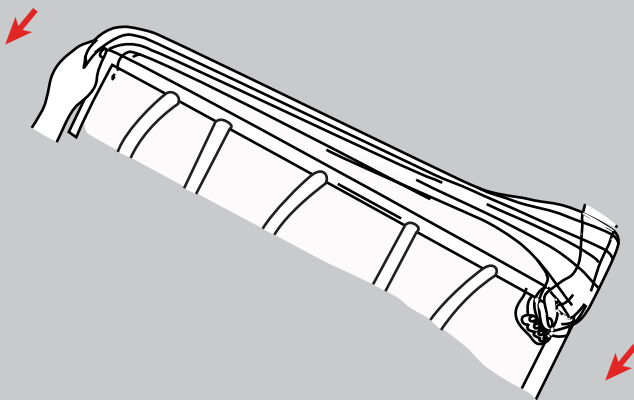

11. Have both people slide the fabric down towards the bottom of the Flat metals and align the edges and corners. Pull the black bottom fabric underneath the frame.

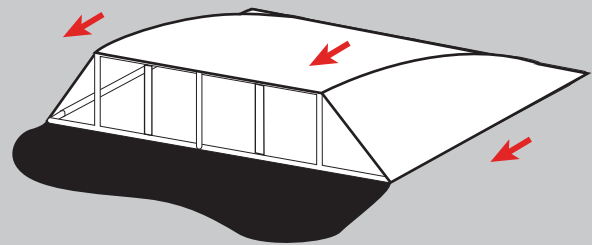

Any and all rights (including, without limitation, copyright, design patent, use patent and trademark) in and to all designs, concepts, renderings, or graphics (collectively, "Design") represented in this document were created by Moss Inc. and remain the sole and exclusive property of Moss Inc. Use of any such Design by the recipient without required purchase is strictly prohibited. ©2010

12. Zip the black bottom fabric to the main fabric. The zipper runs along the sides and back of the bottom edge.

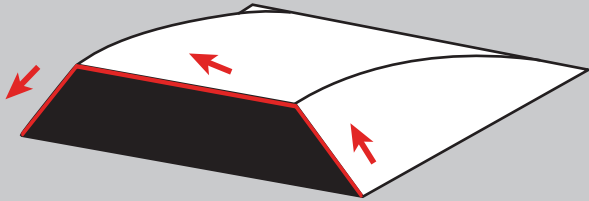

13. Have one person pull the fabric over the metal while another one zips. The fabric is strong, so we encourage pulling hard!

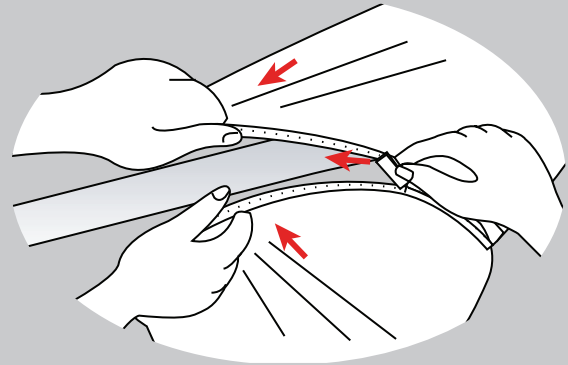

14. Stand and place in desired location using both people. Please try not to drag the pieces. Make sure corners and seams are straight.

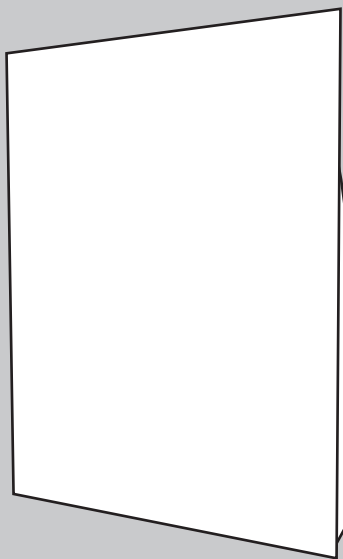

#### Final Note:

##### Metals:

After use, dismantle. Each metal is labeled, so please place back in corresponding labeled bag. If possible, zip-tie pieces together.

Under NO circumstances should the metals be taped to one another.

##### Fabric:

Each fabric is labeled on the Pink Inc. tag and should be placed back in the corresponding labeled bag.

Any and all rights (including, without limitation, copyright, design patent, use patent and trademark) in and to all designs, concepts, renderings, or graphics (collectively, "Design") represented in this document were created by Moss Inc. and remain the sole and exclusive property of Moss Inc. Use of any such Design by the recipient without required purchase is strictly prohibited. ©2010