

PINK PROVIDES:

- 2 Black Base Covers
- 2 Pole Covers
- 1 Cross Bar Cover
- 1 10'x10' Circle Surround

YOU PROVIDE:

- 2 10' Auto-Poles
- 2 Base Plates
- 1 10' Cross Bar
- Two Person Team
- Shears or Diagonal Cutters
- Zip-Ties

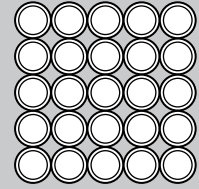

Additional Support Please Call:
212-253-6666 or
After Hours: 646-853-3900

If base plate is not assembled, assemble with nipple. Place near final location.

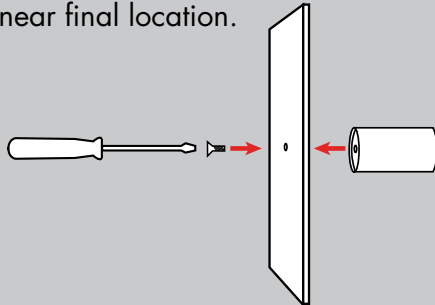

Please note: Heights and width shown are for a standard 10' X 10' setup.

Please refer to the product instruction page for correct dimensions.

1. Place the base cover onto the base plate as indicated below.

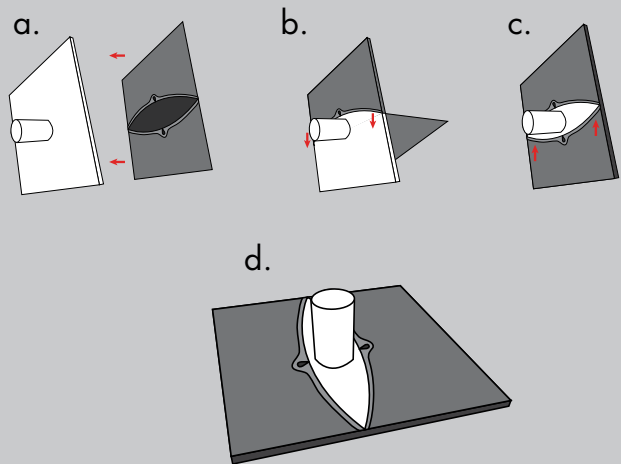

2. Preset the auto-poles to the correct height. Then slide the pole covers over the auto-poles.

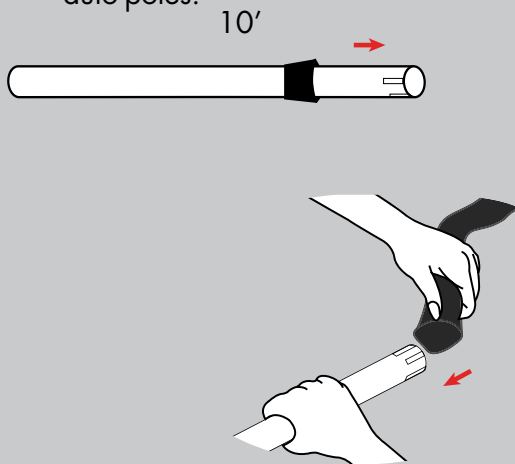

3. Lay the auto-poles near the assembled base plates. The auto-poles should be preset to the correct height and covered.

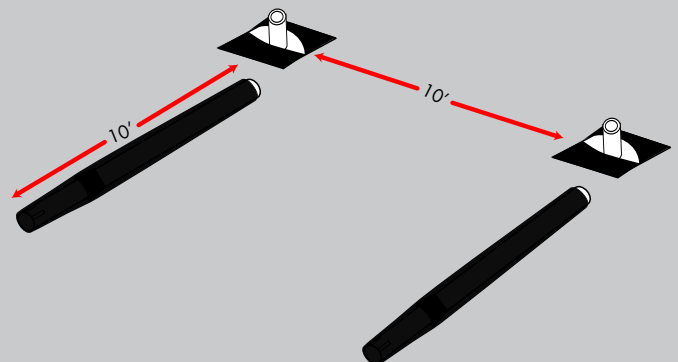

Any and all rights (including, without limitation, copyright, design patent, use patent and trademark) in and to all designs, concepts, renderings, or graphics (collectively, "Design") represented in this document were created by Moss Inc. and remain the sole and exclusive property of Moss Inc. Use of any such Design by the recipient without required purchase is strictly prohibited. ©2010

4. Preset the cross bar to the correct width. Then slide the cross bar cover over cross bar.

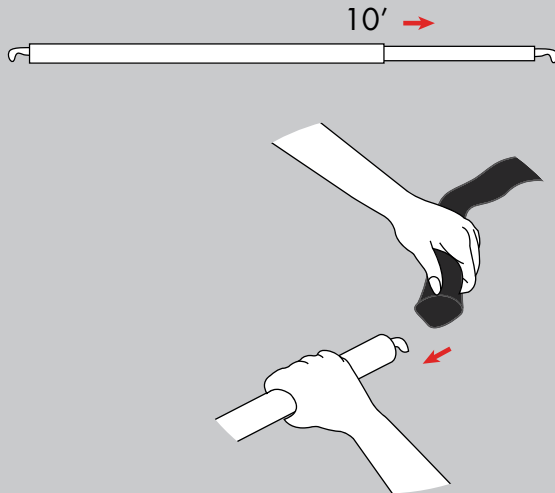

5. The pole has notches and slots. It is important to always work with the slots when using Pink Inc. products. Slide the cross bar into the slots on each side.

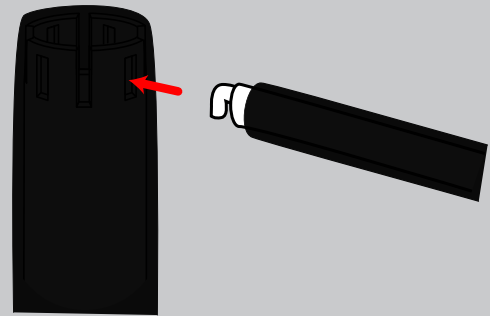

6. After sliding the cross bars into the slots, push down to set in place.

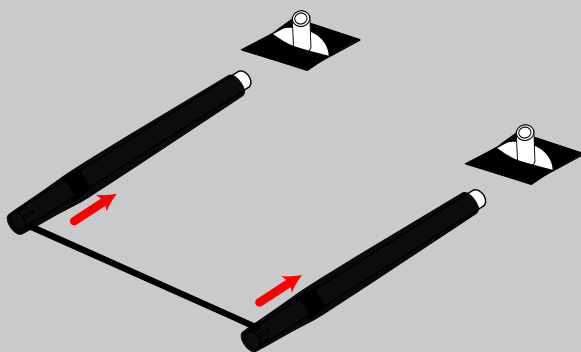

7. The fabric is made out of twenty-five pre-attached circles. Open the folded Surround.

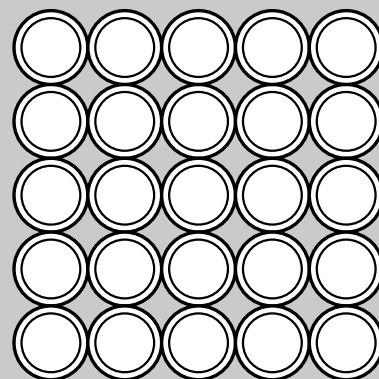

Any and all rights (including, without limitation, copyright, design patent, use patent and trademark) in and to all designs, concepts, renderings, or graphics (collectively, "Design") represented in this document were created by Moss Inc. and remain the sole and exclusive property of Moss Inc. Use of any such Design by the recipient without required purchase is strictly prohibited. ©2010

8. Using zip-ties, loosely attach the top five circles to the cross bar. It is important that these points are not tightened as they may need to be shifted.

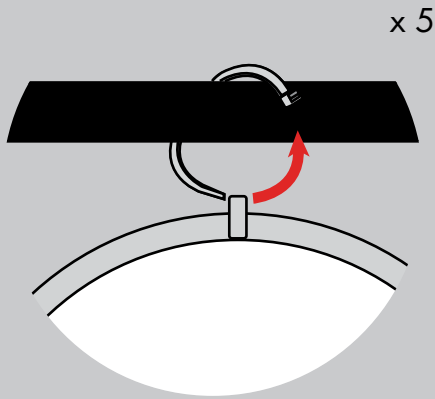

9. Straighten the Surround so it is laying evenly between the poles. Tighten the zip-ties at the top fully and snip tails.

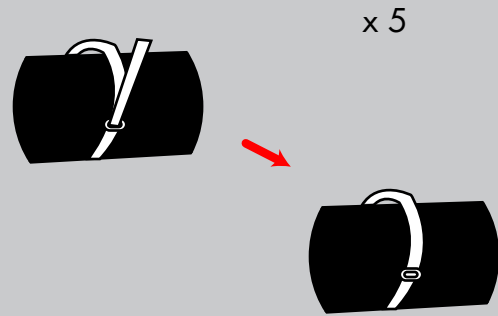

10. Now stretch the side points to the poles and attach with zip-ties. Connect circles from the top to the bottom. Tighten and snip tails as in step 9. If using small zip-ties, 2 may be needed to span the pole.

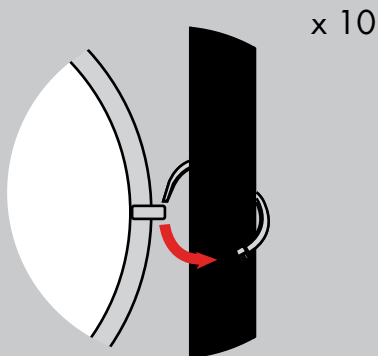

11. Using two people, one per pole, lift the Circle Surround onto the preset base plates.

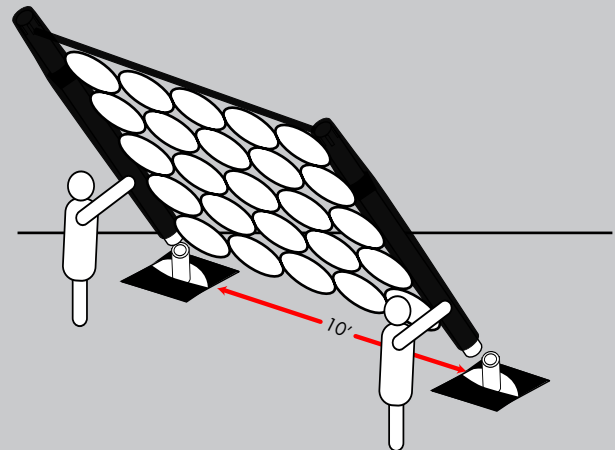

Any and all rights (including, without limitation, copyright, design patent, use patent and trademark) in and to all designs, concepts, renderings, or graphics (collectively, "Design") represented in this document were created by Moss Inc. and remain the sole and exclusive property of Moss Inc. Use of any such Design by the recipient without required purchase is strictly prohibited. ©2010

12a. The bottom of the Surround hangs free.

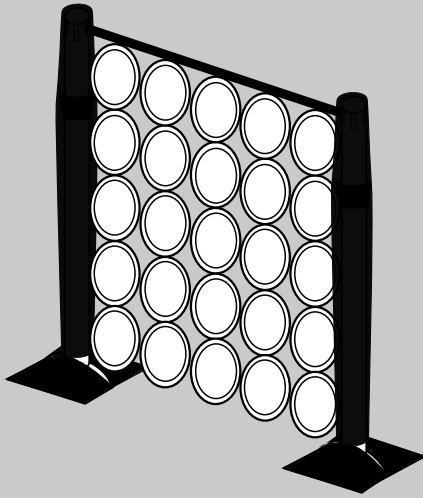

12b. Rigging Surround:

Determine rigging points. You will need to at least rig the five top points of the top circles. However, we do recommend rigging the side points as well to ensure proper tension.

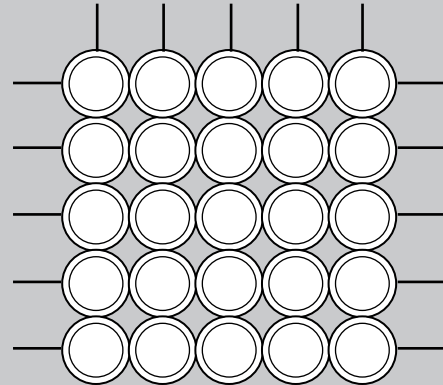

Trouble Shooting:

- When repacking:
 - * Do not snip apart circles; they should be folded in similar condition as how they arrived.
 - * When folding, do not twist and turn the circles. It will become difficult to unfold again at a later date.

- If uncomfortable with the loose bottom:
 - * Add a line through the loops along the bottom.

Any and all rights (including, without limitation, copyright, design patent, use patent and trademark) in and to all designs, concepts, renderings, or graphics (collectively, "Design") represented in this document were created by Moss Inc. and remain the sole and exclusive property of Moss Inc. Use of any such Design by the recipient without required purchase is strictly prohibited. ©2010