

**PINK PROVIDES:**  
2 Black Base Covers  
2 Pole Covers  
1 Cross Bar Cover  
1 Diamond Surround Fabric

**YOU PROVIDE:**  
2 10' Auto-Poles  
2 Base Plates  
1 Cross Bar, 10' - 15' range  
Two Person Team  
4 Sandbags  
Shears or Diagonal Cutters  
Tie Line  
Zip-Ties

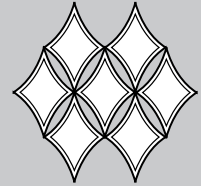

Additional Support Please Call:  
212-253-6666 or  
After Hours: 646-853-3900

If base plate is not assembled, assemble with nipple. Place near final location.

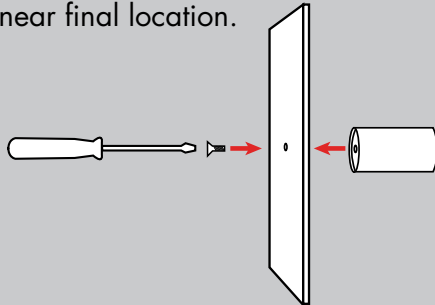

Please note: Heights and width shown are for a standard 10' X 10' setup.

Please refer to the product instruction page for correct dimensions.

1. Place the base cover onto the base plate as indicated below.

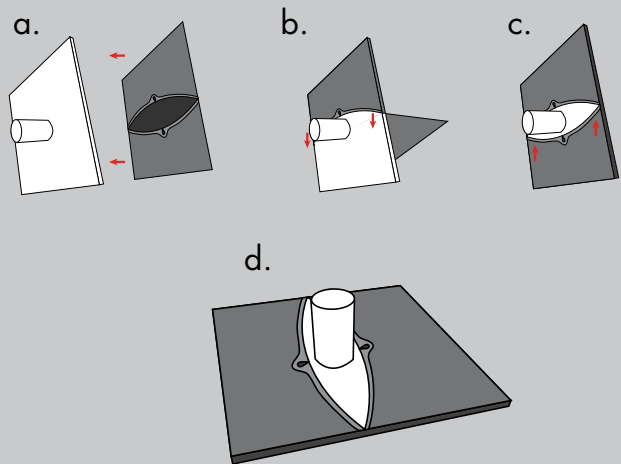

2. Preset the auto-poles to the correct height. Then slide the pole covers over the auto-poles.

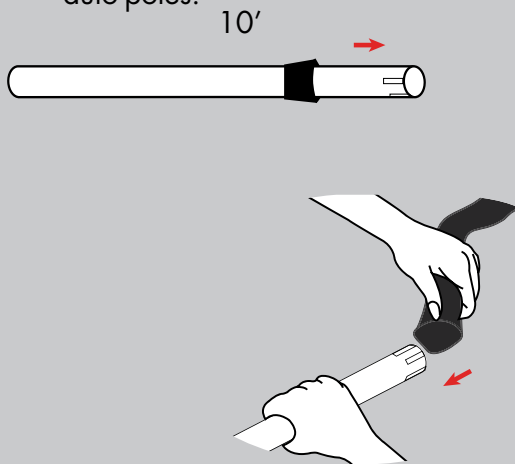

3. Lay the auto-poles near the assembled base plates. The auto-poles should be preset to the correct height and covered.

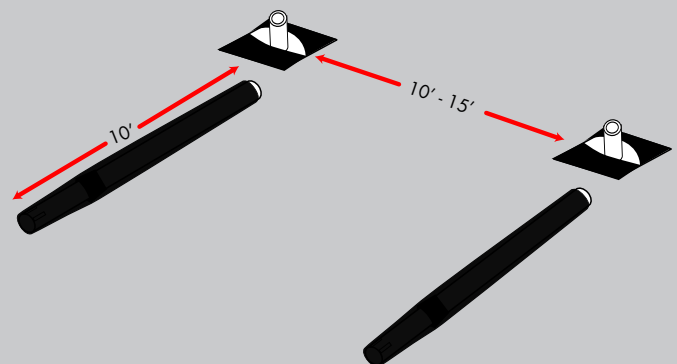

Any and all rights (including, without limitation, copyright, design patent, use patent and trademark) in and to all designs, concepts, renderings, or graphics (collectively, "Design") represented in this document were created by Moss Inc. and remain the sole and exclusive property of Moss Inc. Use of any such Design by the recipient without required purchase is strictly prohibited. ©2010

4. Depending on available space, preset the cross bar to the correct width. Then slide the cross bar cover over cross bar. 15' will allow the diamonds to be fully stretched.

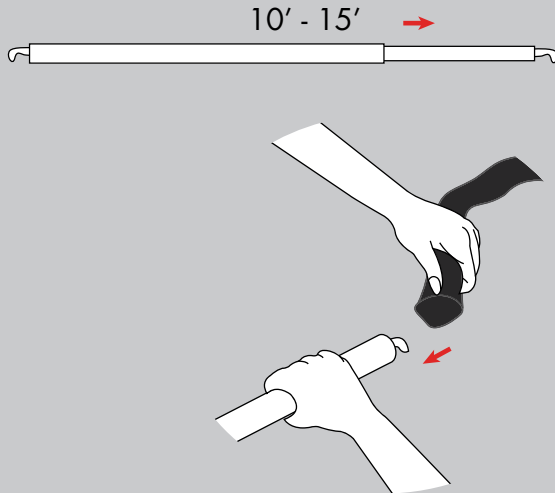

5. The pole has notches and slots. It is important to always work with the slots when using Pink Inc. products. Slide the cross bar into the slots on each side.

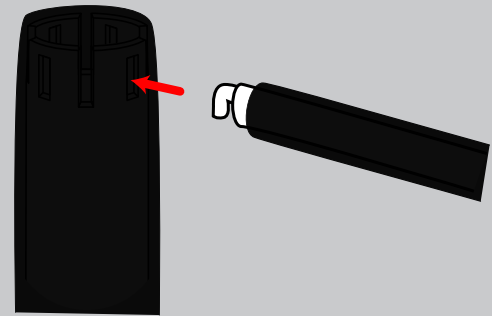

6. After sliding the cross bars into the slots, push down to set in place.

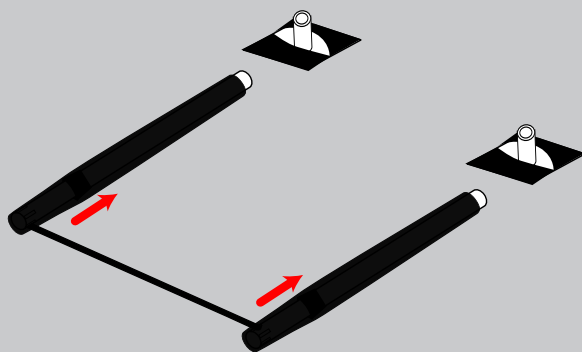

7. The fabric is made out of twenty-five pre-attached circles. Open the folded Surround.

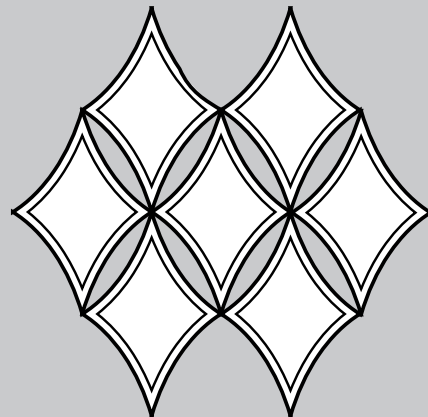

Any and all rights (including, without limitation, copyright, design patent, use patent and trademark) in and to all designs, concepts, renderings, or graphics (collectively, "Design") represented in this document were created by Moss Inc. and remain the sole and exclusive property of Moss Inc. Use of any such Design by the recipient without required purchase is strictly prohibited. ©2010

8. Using zip-ties, loosely attach the top two points to the cross bar. It is important that these points are not tightened as they may need to be shifted.

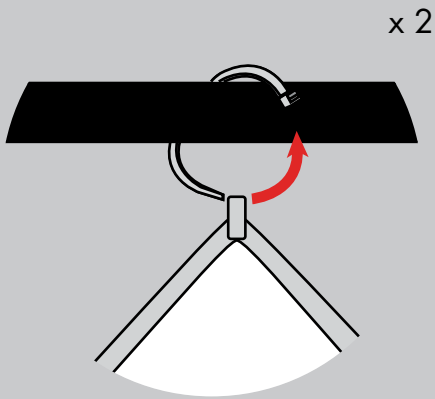

9. Now stretch the side points to the poles and attach with zip ties, 5' down from the cross bar. Do not tighten completely as these may also need to be shifted. If using small zip-ties, you may need two in order to go around the pole.

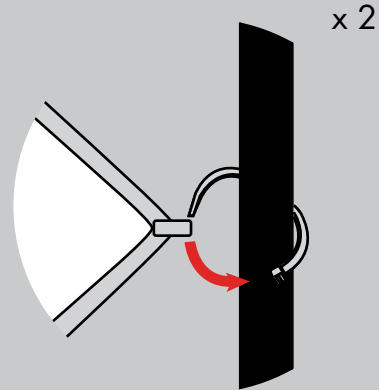

10. Add tie line from the Surround to the corners of the pipe and base as indicated.

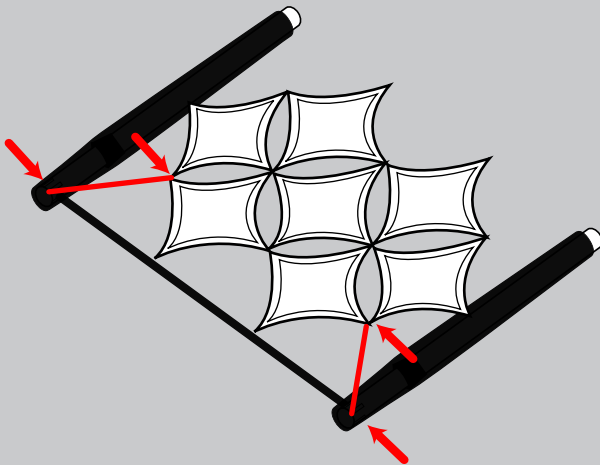

11. Straighten the Surround so it is positioned evenly between the poles. Tighten the zip-ties at the top and snip tails.

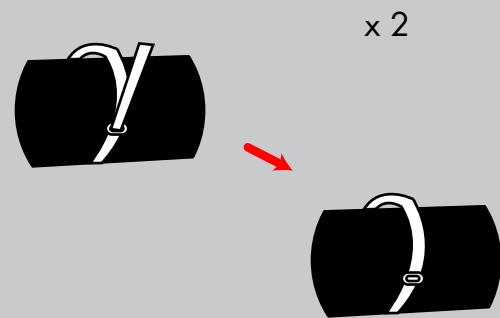

Any and all rights (including, without limitation, copyright, design patent, use patent and trademark) in and to all designs, concepts, renderings, or graphics (collectively, "Design") represented in this document were created by Moss Inc. and remain the sole and exclusive property of Moss Inc. Use of any such Design by the recipient without required purchase is strictly prohibited. ©2010

12. Using two people, one per pole, lift the Diamond Surround onto the preset base plates. Lift slowly and evenly, and watch the cross bar in case it falls loose.

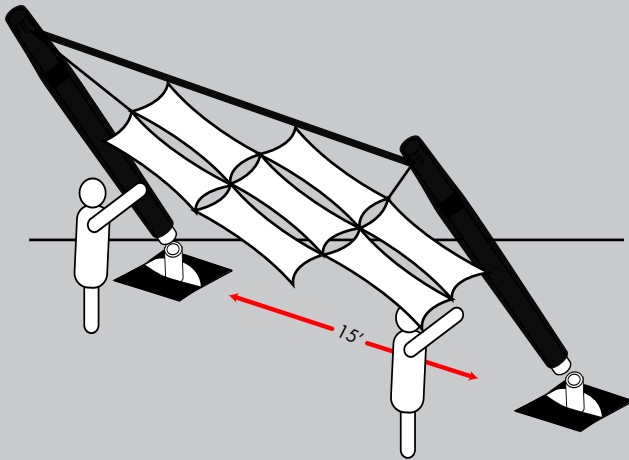

13. Rigging Surround:  
Determine rigging points. You will need to at least rig the five top points of the top circles. However, we do recommend rigging the side points as well to ensure proper tension.

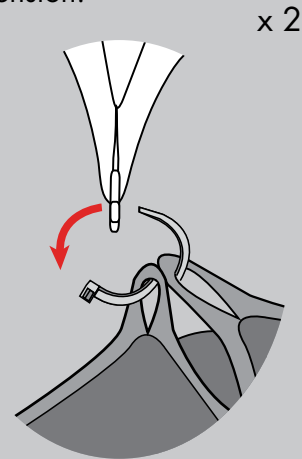

14. Add tie line from the Surround to the corners of the pipe and base as indicated:

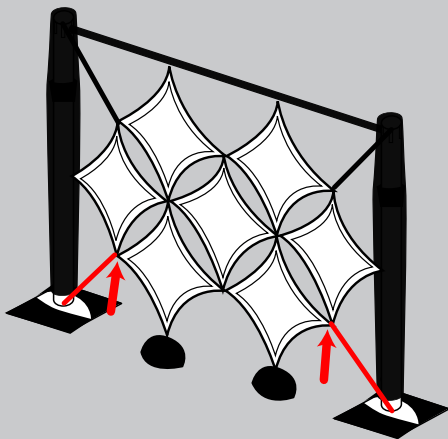

15. If width is less than 15', skip to step 17. Shift side points of Surround as needed. Tighten the zip-ties and snip tails.

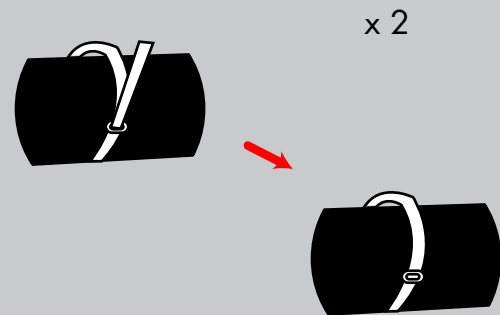

Any and all rights (including, without limitation, copyright, design patent, use patent and trademark) in and to all designs, concepts, renderings, or graphics (collectively, "Design") represented in this document were created by Moss Inc. and remain the sole and exclusive property of Moss Inc. Use of any such Design by the recipient without required purchase is strictly prohibited. ©2010

16. The Diamond Surround is complete.

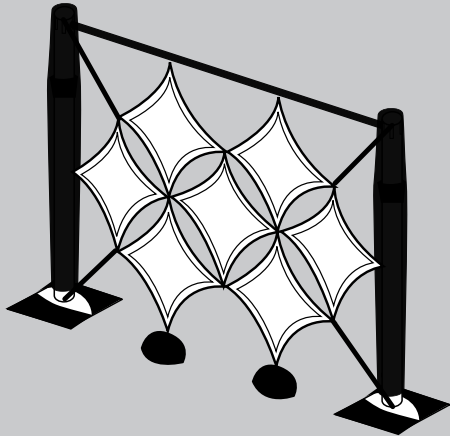

17. For spans less than 15', snip the side zip-ties. Fold the corners back and around the poles, and attach them to each other behind the Surround using tie-line.

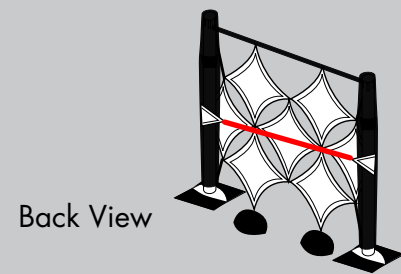
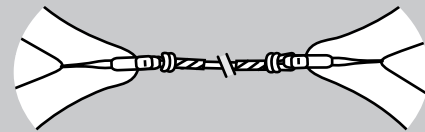

#### Trouble Shooting:

- If wrinkles are present:
  - \* Stretch further;
  - \* You may add tie line in the back of the Surround between the two side points; this will make the corners fold back around the pole (shown in step 17;)
  - \* Tighten tie line between corners.
- If sandbags are lifting:
  - \* Add another sandbag on top of the current one; the extra weight will hold it in place.

Any and all rights (including, without limitation, copyright, design patent, use patent and trademark) in and to all designs, concepts, renderings, or graphics (collectively, "Design") represented in this document were created by Moss Inc. and remain the sole and exclusive property of Moss Inc. Use of any such Design by the recipient without required purchase is strictly prohibited. ©2010